

# ELECTRONIC TIME RECORDER

With TFT Color Touch panel

High visibility / Natural instinct of the human-Easy for setting



Patent no. M510509

# A. OVERVIEW

## External View

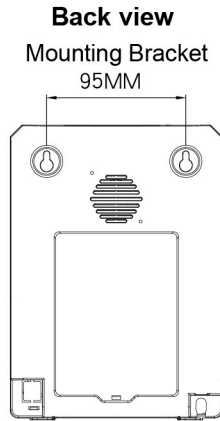
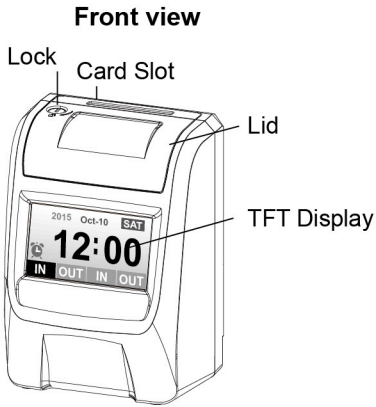

## TFT setting panel

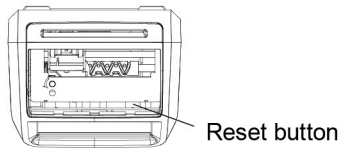
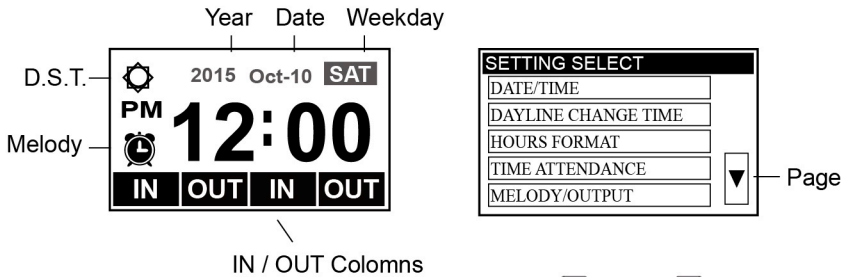

# B. WHAT YOU HAVE

- Manual book
- A pair of key

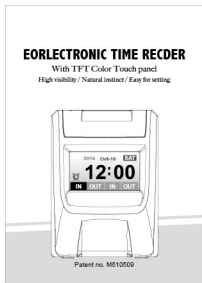

## C. PROGRAMMING MODE

To remove the cover enter programming mode

▲ ▼ Page Up / Down , + - Gain / Reduce value

← Back , DEL Delete

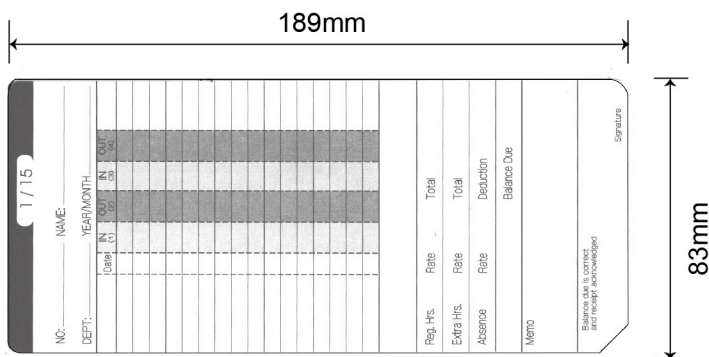

### Setting Items

1. DATE/TIME
2. DAYLINE CHANGE TIME
3. HOURS FORMAT
4. DAYLIGHT SAVING TIME
5. TIME ATTENDANCE
6. MELODY/OUTPUT
7. PRINTING COLUMN
8. PRINTING FORMAT
9. TIME CARD TYPE
10. PRINTING POSITION
11. CARD AUTO DETECTION
12. VR. ADJUST
13. BRIGHTNESS
14. LANGUAGE

## D. BEFORE START

1. Always plug the machine into the correct power source.
2. Enter the key and turn clockwise to open the lid, reverse to replace the lid.
3. Ribbon replacement

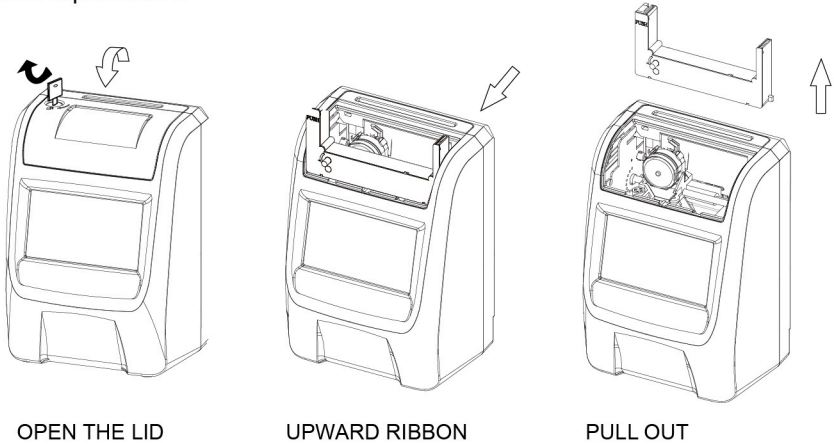

4. Keep away from heat radiators, air dust, moisture and mechanical shock vibration.
5. Do not allow any sharp, solid objects or liquid to fall onto/into the machine or touch setting panel.

## E. SPECIFICATION

Power rating: Refer to the label plate on back of each machine

Dimensions: 12.0 X 14.5 X 20 Cm<sup>3</sup> (D x W X H)

Weight: 1.6 kgs

Appropriate temperature range: 0 °C - 40°C

Condition: 10-80% RH